

# Lichfield Street, Rugeley, WS15 2EH

£170,000

🛏️ 2 🚿 1 🛋️ 1



**\*\* ONLINE VIRTUAL TOUR AVAILABLE ON THIS PROPERTY - why not take a peek before booking a viewing\*\***

## Key Features

- TOWN CENTRE LOCATION
- IDEAL INVESTMENT
- CLOSE TO LOCAL AMENITIES
- 
- 
- 
- 
- 

Approx Gross Internal Area  
71 sq m / 759 sq ft

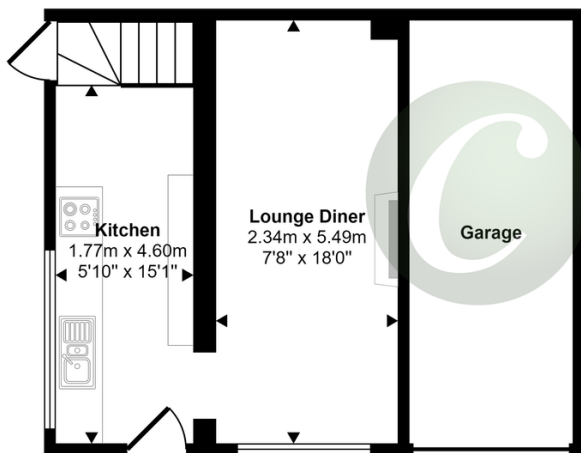

Ground Floor  
Approx 36 sq m / 392 sq ft

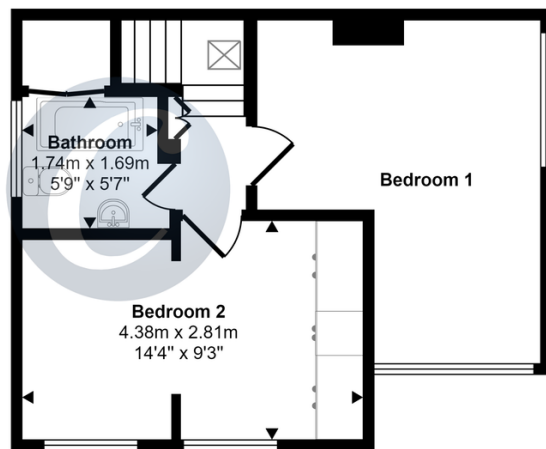

First Floor  
Approx 34 sq m / 367 sq ft

This floorplan is only for illustrative purposes and is not to scale. Measurements of rooms, doors, windows, and any items are approximate and no responsibility is taken for any error, omission or mis-statement. Icons of items such as bathroom suites are representations only and may not look like the real items. Made with Made Snappy 360.